

## MAGNETIC VARIATION 8° W (2020)

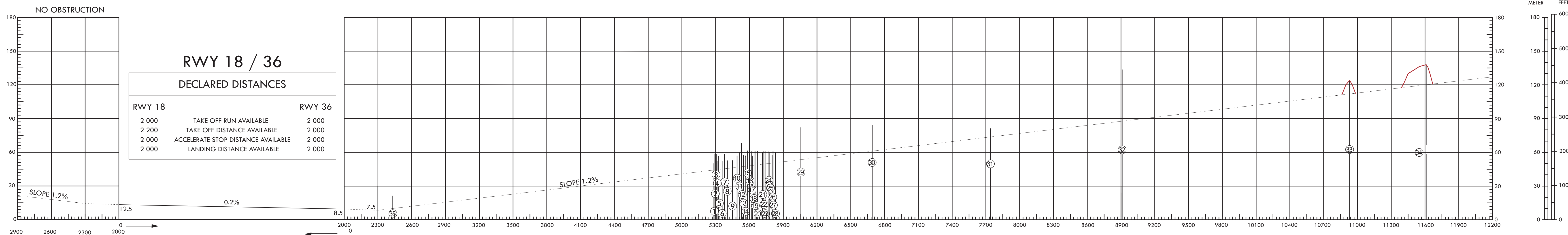

VERTICAL SCALE 1: 1 500

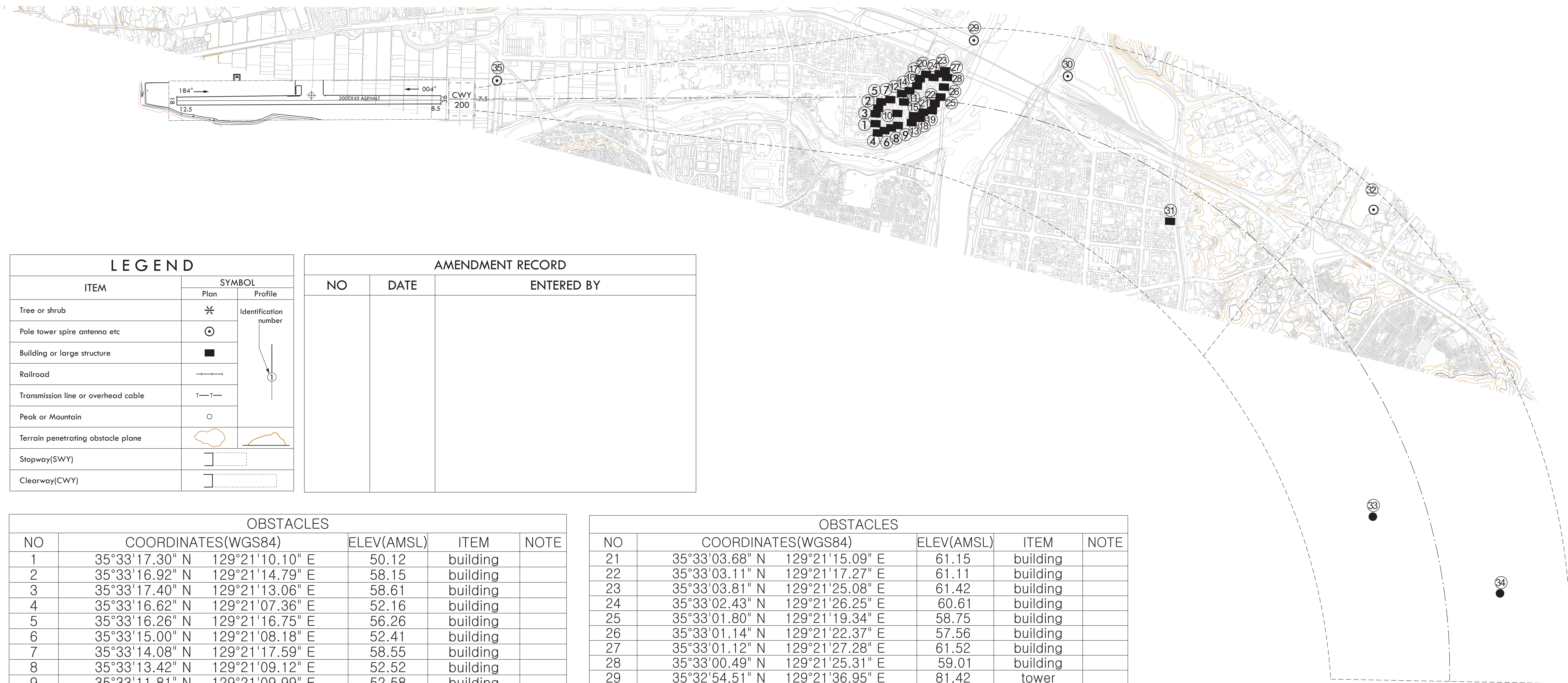

LEGEND		
ITEM	SYMBOL	
	Plan	Profile
Tree or shrub		
Pole tower spire antenna etc		
Building or large structure		
Railroad		
Transmission line or overhead cable		
Peak or Mountain		
Terrain penetrating obstacle plane		
Stopway(SWY)		
Clearway(CWY)		

AMENDMENT RECORD		
NO	DATE	ENTERED BY

OBSTACLES					
NO	COORDINATES(WGS84)		ELEV(AMSL)	ITEM	NOTE
1	35°33'17.30" N	129°21'10.10" E	50.12	building	
2	35°33'16.92" N	129°21'14.79" E	58.15	building	
3	35°33'17.40" N	129°21'13.06" E	58.61	building	
4	35°33'16.62" N	129°21'07.36" E	52.16	building	
5	35°33'16.26" N	129°21'16.75" E	56.26	building	
6	35°33'15.00" N	129°21'08.18" E	52.41	building	
7	35°33'14.08" N	129°21'17.59" E	58.55	building	
8	35°33'13.42" N	129°21'09.12" E	52.52	building	
9	35°33'11.81" N	129°21'09.99" E	52.58	building	
10	35°33'12.13" N	129°21'13.59" E	57.91	building	
11	35°33'10.67" N	129°21'17.14" E	60.25	building	
12	35°33'11.28" N	129°21'19.63" E	57.75	building	
13	35°33'08.47" N	129°21'11.07" E	57.38	building	
14	35°33'09.51" N	129°21'20.62" E	57.82	building	
15	35°33'08.06" N	129°21'13.20" E	61.45	building	
16	35°33'07.72" N	129°21'22.23" E	60.62	building	
17	35°33'07.12" N	129°21'24.46" E	60.65	building	
18	35°33'06.55" N	129°21'12.54" E	56.71	building	
19	35°33'05.76" N	129°21'14.42" E	61.02	building	
20	35°33'05.70" N	129°21'25.85" E	61.34	building	

OBSTACLES					
NO	COORDINATES(WGS84)		ELEV(AMSL)	ITEM	NOTE
21	35°33'03.68" N	129°21'15.09" E	61.15	building	
22	35°33'03.11" N	129°21'17.27" E	61.11	building	
23	35°33'03.81" N	129°21'25.08" E	61.42	building	
24	35°33'02.43" N	129°21'26.25" E	60.61	building	
25	35°33'01.80" N	129°21'19.34" E	58.75	building	
26	35°33'01.14" N	129°21'22.37" E	57.56	building	
27	35°33'01.12" N	129°21'27.28" E	61.52	building	
28	35°33'00.49" N	129°21'25.31" E	59.01	building	
29	35°32'54.51" N	129°21'36.95" E	81.42	tower	
30	35°32'30.92" N	129°21'27.96" E	84.22	tower	
31	35°32'03.63" N	129°20'46.37" E	81.00	building	
32	35°31'13.94" N	129°20'53.71" E	133.47	tower	
33	35°31'09.38" N	129°19'21.64" E	124.00	mountain	
34	35°30'37.03" N	129°19'01.06" E	138.00	mountain	
35	35°34'50.73" N	129°21'15.88" E	17.241	tower	

## ORDER OF ACCURACY

HORIZONTAL SCALE 1 : 15 000

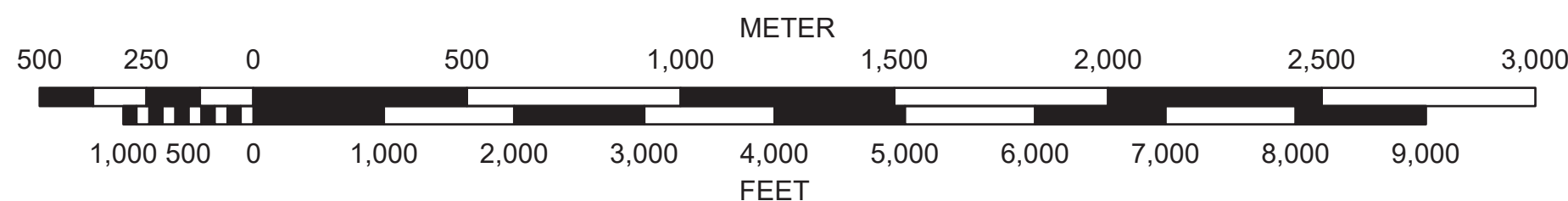



MAGNETIC VARIATION 8° W (2020)

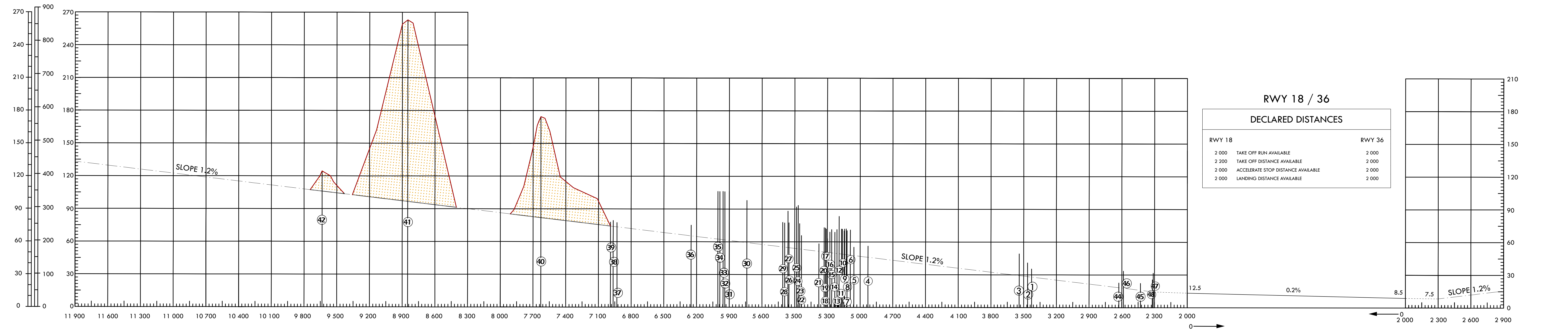

VERTICAL SCALE 1: 1 500

AMENDMENT RECORD		
NO	DATE	ENTERED BY

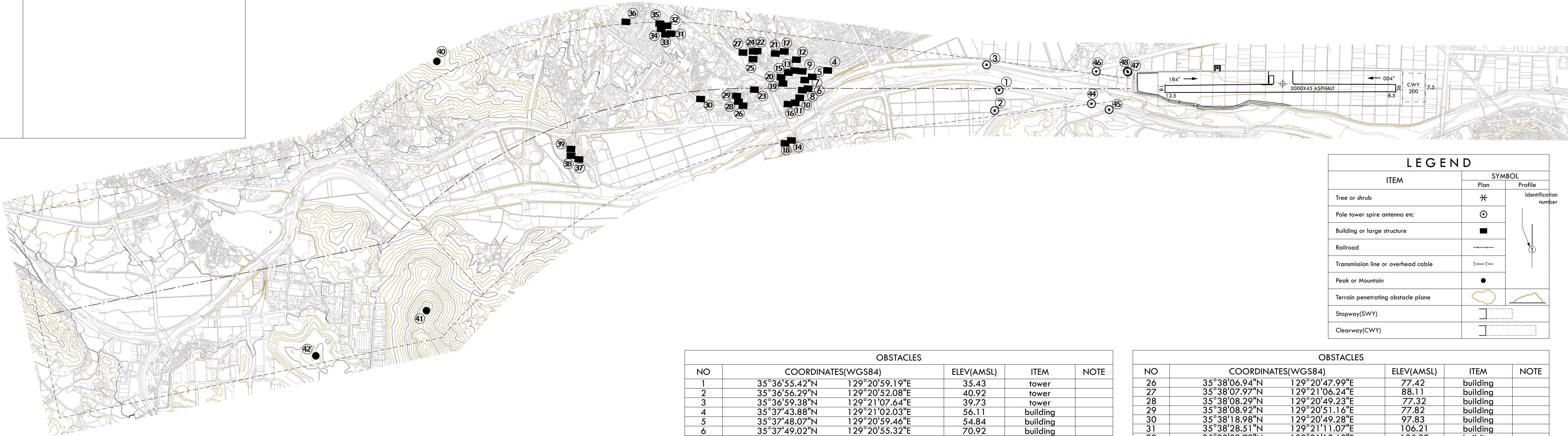

ITEM	SYMBOL	
	Plan	Profile
Tree or shrub	✱	Identification number
Pole tower spire antenna etc	⊙	Identification number
Building or large structure	■	Identification number
Railroad	—+—	Identification number
Transmission line or overhead cable	—+—	Identification number
Peak or Mountain	●	Identification number
Terrain penetrating obstacle plane	○	Identification number
Stopway(SWY)	—+—	Identification number
Clearway(CWY)	—+—	Identification number

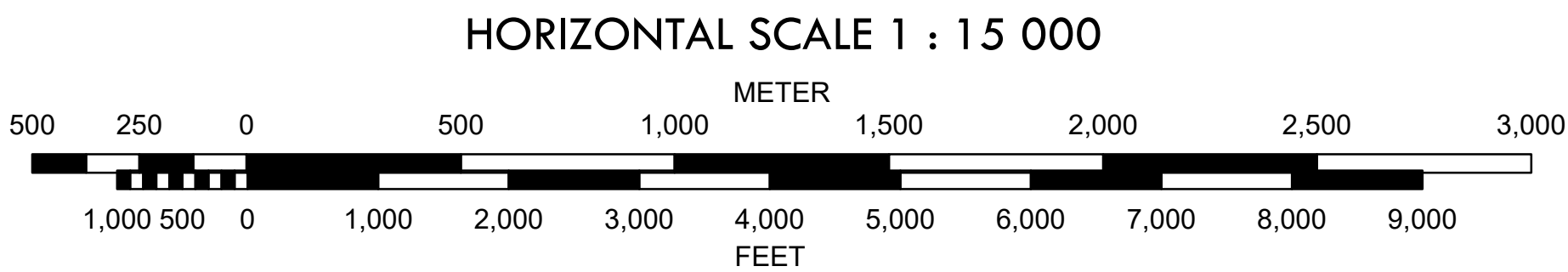

ORDER OF ACCURACY

HORIZONTAL 5.0m  
VERTICAL 0.5m

OBSTACLES				
NO	COORDINATES(WGS84)		ELEV(AMSL)	ITEM
1	35°36'55.42"N	129°20'59.19"E	35.43	tower
2	35°36'56.29"N	129°20'52.08"E	40.92	tower
3	35°36'59.38"N	129°21'07.64"E	39.73	tower
4	35°37'43.88"N	129°21'02.03"E	56.11	building
5	35°37'48.07"N	129°20'59.46"E	54.84	building
6	35°37'49.02"N	129°20'55.32"E	70.92	building
7	35°37'50.11"N	129°20'58.21"E	70.34	building
8	35°37'50.57"N	129°20'54.67"E	71.78	building
9	35°37'51.01"N	129°21'01.17"E	70.04	building
10	35°37'51.22"N	129°20'52.02"E	71.62	building
11	35°37'52.38"N	129°20'50.16"E	71.67	building
12	35°37'52.83"N	129°21'04.98"E	53.62	building
13	35°37'53.14"N	129°21'01.24"E	71.23	building
14	35°37'52.73"N	129°20'37.14"E	68.83	building
15	35°37'54.84"N	129°21'00.37"E	71.27	building
16	35°37'54.34"N	129°20'49.53"E	62.44	building
17	35°37'56.39"N	129°21'07.56"E	63.00	building
18	35°37'54.42"N	129°20'36.03"E	68.91	building
19	35°37'56.19"N	129°20'56.53"E	71.79	building
20	35°37'56.83"N	129°20'58.58"E	71.90	building
21	35°37'58.87"N	129°21'06.65"E	58.31	building
22	35°38'04.03"N	129°21'07.09"E	65.81	building
23	35°38'04.04"N	129°20'53.75"E	76.73	building
24	35°38'05.07"N	129°21'06.81"E	93.42	building
25	35°38'05.03"N	129°21'04.18"E	91.91	building

OBSTACLES				
NO	COORDINATES(WGS84)		ELEV(AMSL)	ITEM
26	35°38'06.94"N	129°20'47.99"E	77.42	building
27	35°38'07.97"N	129°21'06.24"E	88.11	building
28	35°38'08.29"N	129°20'49.23"E	77.32	building
29	35°38'08.92"N	129°20'51.16"E	77.82	building
30	35°38'18.98"N	129°20'49.28"E	97.83	building
31	35°38'28.51"N	129°21'11.07"E	106.21	building
32	35°38'29.79"N	129°21'13.68"E	105.93	building
33	35°38'30.02"N	129°21'10.72"E	106.12	building
34	35°38'31.34"N	129°21'12.48"E	106.01	building
35	35°38'31.82"N	129°21'14.24"E	106.13	building
36	35°38'41.38"N	129°21'14.07"E	104.92	building
37	35°38'51.96"N	129°20'25.76"E	77.51	building
38	35°38'54.23"N	129°20'26.81"E	79.41	building
39	35°38'54.39"N	129°20'29.12"E	77.92	building
40	35°39'33.67"N	129°20'56.15"E	174.51	mountain
41	35°39'31.91"N	129°19'30.27"E	263.01	mountain
42	35°40'02.09"N	129°19'12.16"E	124.51	mountain
43	35°43'12.92"N	129°21'34.49"E	349.03	tower
44	35°36'29.24"N	129°20'56.67"E	29.03	tower
45	35°36'24.17"N	129°20'55.07"E	28.30	tower
46	35°36'28.53"N	129°21'07.86"E	28.27	tower
47	35°36'19.62"N	129°21'08.34"E	23.568	tower
48	35°36'19.79"N	129°21'08.64"E	21.715	tower